

## SELF CONTAINED EMERGENCY SIGNALING

### CHARACTERISTICS

**230V** 230V - 50/60Hz

**CE** Marcado CE  
CE marked

**IP** IP40

**Class II**  
Class II

- Maintained - Non maintained.
- Self-test and test button.
- Bicolor (green - red) signaling LED.
- Protection: overload and end battery discharge.
- Acrylic diffuser of 4 mm width.
- Ceiling and wall surface mounting.
- Battery charging: 24 hours.

### DIMENSIONS

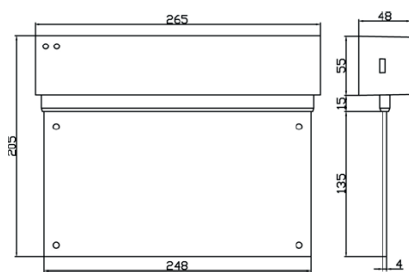

### FUNCTIONING

#### SELF-TEST:

- Switch off the mains power, install and connect the luminaire to the mains supply.
- Check that green LED go on.
- Batteries are supplied discharged.

- Monthly test (once a month): Green LED fast flash.

- Annual test (once a year): Green LED slow flash (autonomy test).

#### Test results:

1. Green LED illuminated: correct operation.
2. Red LED illuminated: lamp failure (Short-circuit LED, open circuit or LED failure).
3. Red LED flashing fast: battery failure (not comply autonomy).
4. Red LED flashing slow: battery failure (incorrect battery or battery disconnected).
5. Green and Red LED off: emergency operation

#### MAINTAINED - NON MAINTAINED:

To configure Maintained- Non maintained operating mode, put the red button in the ON - position.



#### MANUAL VERIFICATION TEST:

Press the test button to initiate a 5 sec. manual function test. Fast flashing green LED.

#### RESET:

- Lamp failure: Power off the mains, disconnect battery before connect the lamp, press the test button to start manual test.
- Autonomy failure: Press test button for 12 sec. and the commissioning test is restarted. If passes the test, the red LED turns off.

## MAINTENANCE

- Batteries should be replaced once their duration gets inferior to the assigned.
- The luminaries should be checked at least once a year by qualified technicians.
- Verify that the mains voltage of the installation is of the appropriate value at the equipment input.
- Batteries and PCB should be re-cycled in adequate way. Make sure the mains supply is switched off.

## INSTALLATION

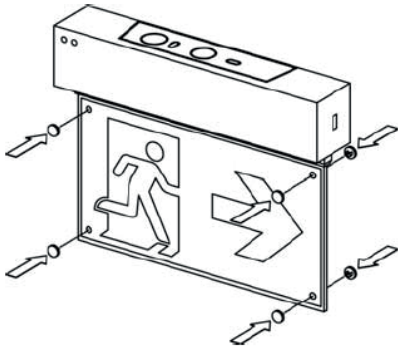

1. Mount pictograms

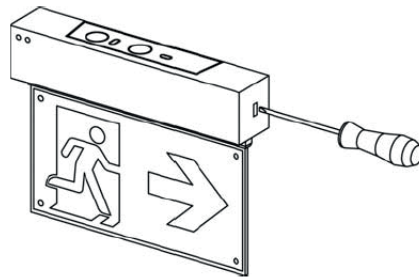

2. Open device

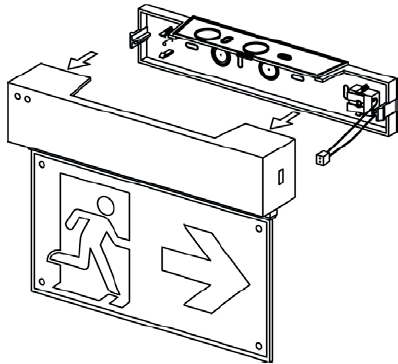

3. Remove pre-plate

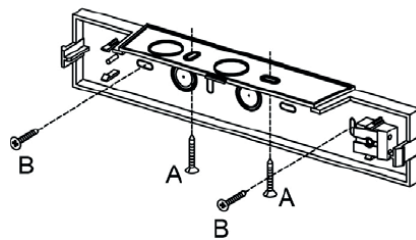

4. Mount pre-plate  
A. Ceiling mounting  
B. Wall surface mounting

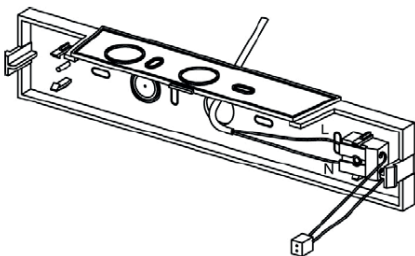

5. Wire up

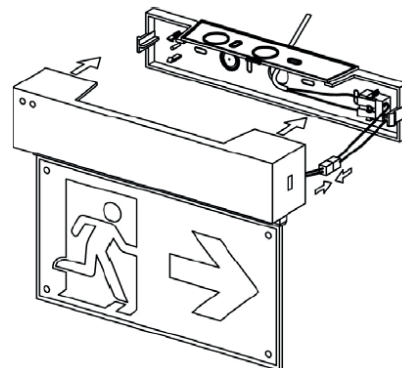

6. Connect and close