

# DCW 117 Mounting instruction

**TAKTON**

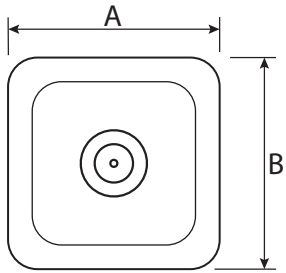

**!** The installation should be carried out by an electrician or by any similarly qualified person.



	A	B	C	D
2ft	75	63	670	200
4ft	75	63	1230	200
5ft	75	63	1510	200

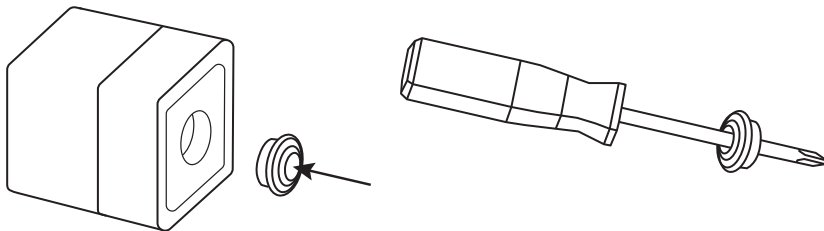
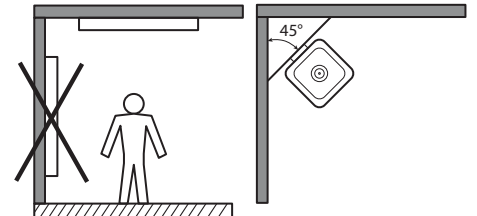
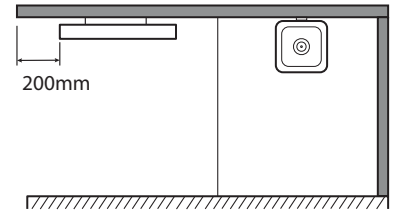
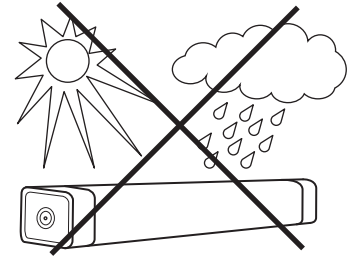
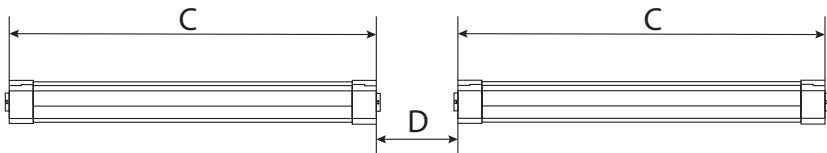

IP65 option



IP66 option

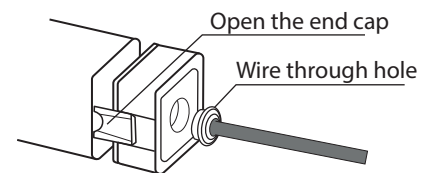
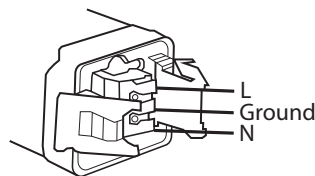
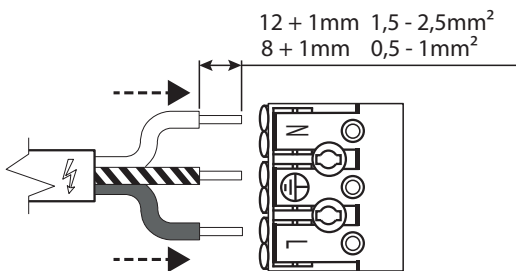

1. Please operate the wiring when the power is off
2. After the wiring is complete, the IP65 waterproof rating can only be achieved after the end cover is covered.

A: Ceiling Installation

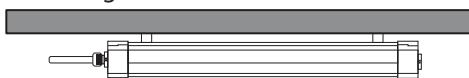

B: Suspended Installation



C: Serial/Linkable Connection

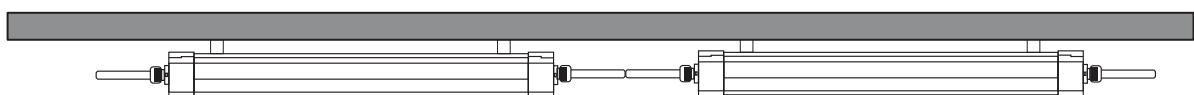

Macro Series connection requirements: link up to 1800W (220V)  
cable length is within 100 meters

